



Lexington

West 13th and Adams Street, Lexington, Nebraska

The project

Lexington is planning extensive plantings on the peninsula in Plum Creek Park Lake. Recently the City undertook a **lake restoration** during which a number of trees were removed. This project will begin the **replenishment** of the peninsula's plant life, and set the stage for other improvements suggested in a 2013 Park Improvement Plan. The Greener Towns plan calls for 32 deciduous **trees and shrubs**. Following the project Ag **students** from the high school will fill in areas with a variety of ornamental grasses they **produced in their greenhouse**. The tree planting will take place in April and May of 2018.



An outdoor seating ring for outdoor classroom visits and other activities was installed among the new trees.

What we learned

- 1 Take time to develop a planting plan.
- 2 Be prepared to embrace a plan that wasn't originally envisioned.
- 3 State Foresters are knowledgeable and want to help achieve excellent results.



Wild Plum
Prunus americana



False Indigo
Amorpha fruticosa



Black Willow
Salix nigra



Triumph Elm
Ulmus americana

Who's involved & costs

- Lexington Lions Club
- Lexington Senior High School Students
- Nebraska Statewide Arboretum
- Project Green Team

\$5,000

PAID BY GREENER TOWNS

\$--

PAID BY OTHER GRANTS

\$1,120

PAID LOCALLY

\$4,850

DONATED TIME/GOODS

\$10,970

PROJECT VALUE

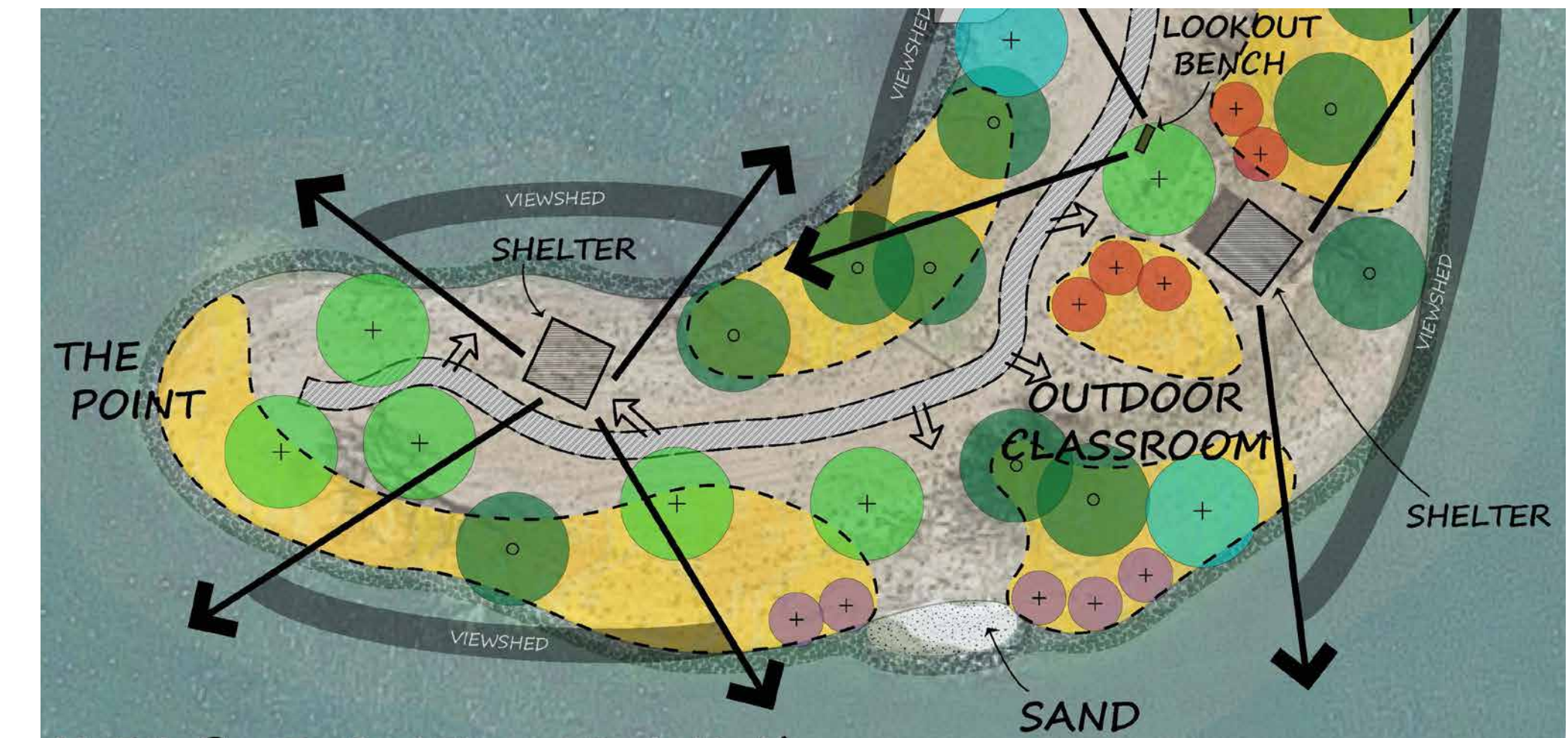

Concept plan for the park peninsula that focuses on using trees to frame views of the lake.

Trees for Plum Creek Park

GREENER TOWNS

